

# Traffic Control Plan:



**Date:** 30/10/21 **Author:** Gemini Perera **Project:** 130 Pitt Street, Sydney  
**Client:** Renascent **Contact:** Mark Capizzi **Phone:** 0409 722 226

www.invarion.com

**Comments:**

This plan was designed by Gemini Perera of Jim's Traffic Control - Hornsby in accordance with Australian Standards and the TfNSW's Traffic Control at Worksites Manual V6.0. The plan is designed for the safe closure of Pitt Street between Hunter Street and King Street for the setup of mobile crane at 130 Pitt Street Sydney, to lift materials into site. During work traffic will be detoured and pedestrians will be assisted to the other footpath. Certified traffic controllers will be on-site to implement and monitor this TCP. Any questions please contact Dwayne Perera of Jim's Traffic Control - Hornsby on 0400 350 182.

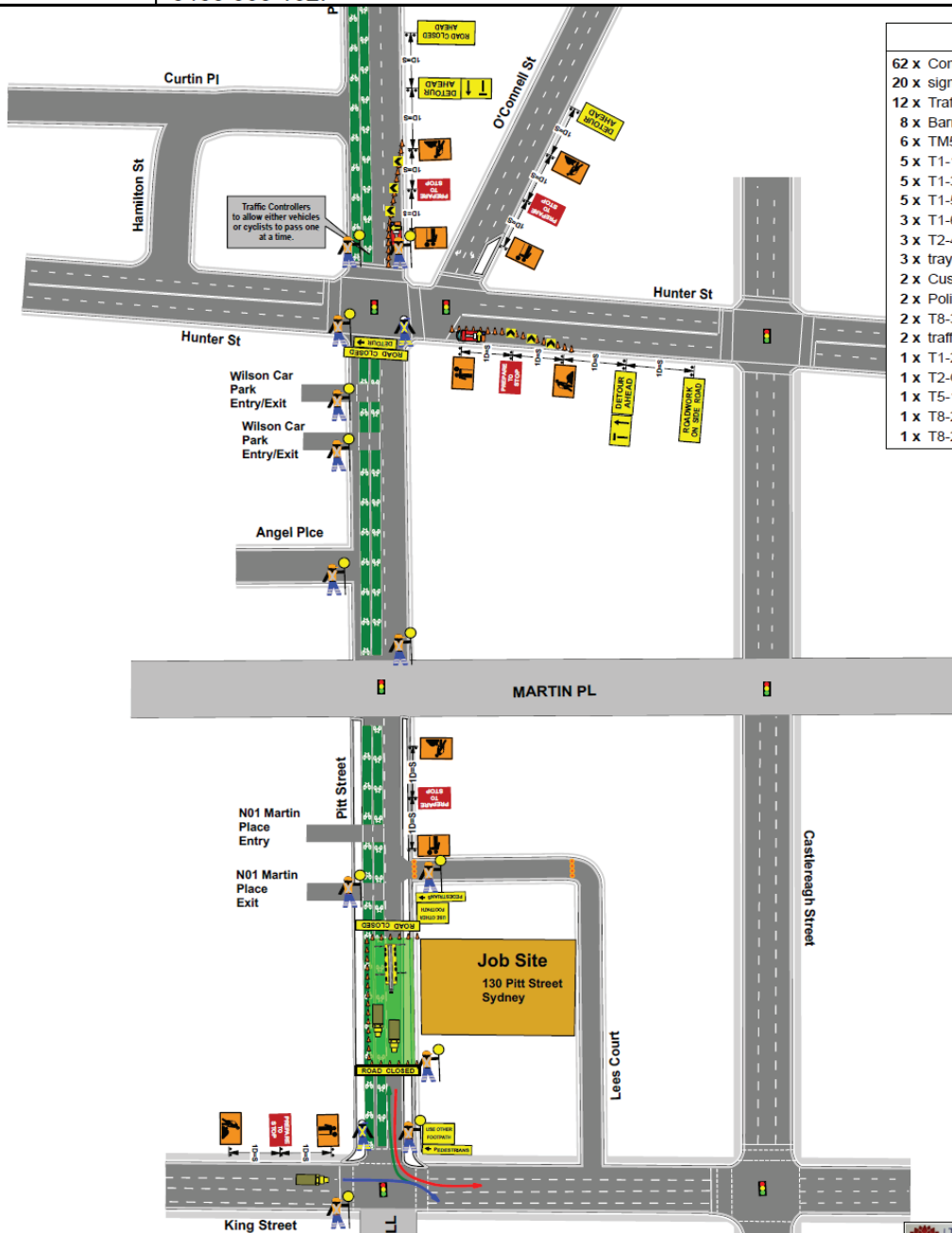

Manifest	
62 x	Cone
20 x	sign single
12 x	Traffic Controller
8 x	Barrel
6 x	TM5-V5 CHEVRON
5 x	T1-18 PREPARE TO STOP
5 x	T1-34 TRAFFIC CONTROLLER AHEAD
5 x	T1-5 WORKERS AHEAD
3 x	T1-6 DETOUR AHEAD
3 x	T2-4 ROAD CLOSED
3 x	tray truck
2 x	Custom
2 x	Police
2 x	T8-3 USE OTHER FOOTPATH
2 x	traffic light
1 x	T1-25 ROADWORK ON SIDE ROAD
1 x	T2-Q02a road closed ahead T2-Q02a
1 x	T5-1 (R) DETOUR LEFT
1 x	T8-2L pedestrians (L)
1 x	T8-2R pedestrians (R)

Legend	
	Barrel
	Cone
	Job Site
	Mobile Crane
	Police
	Traffic Controller
	traffic light
	Work Area

Signs Spacing's	
Estimated Speed Of Traffic (D)	Dimension Range
0-40km	0-5m
50km	15-50m
60km	45-60m
70km	70m
80km	80m
90km	90m
100km	100m

**PLAN NOT TO SCALE**

NSW Transport Roads & Maritime Services  
 Prepare a Work Zone Traffic Management Plan card No. 0052272002  
 This qualification enables you to prepare Traffic Management Plans and conduct inspections on Traffic Management Plans.

GEMINI PERERA  
 Expiry Date: 24/01/2023

This card is not a proof of identity.

# Detour Routes

## Manifest

- 3 x T2-4 road closed
- 3 x T5-1 (L) detour (L)
- 2 x T5-1 (R) detour (R)

